

# RMS-7017001A - CORE MANUAL CLUTCH

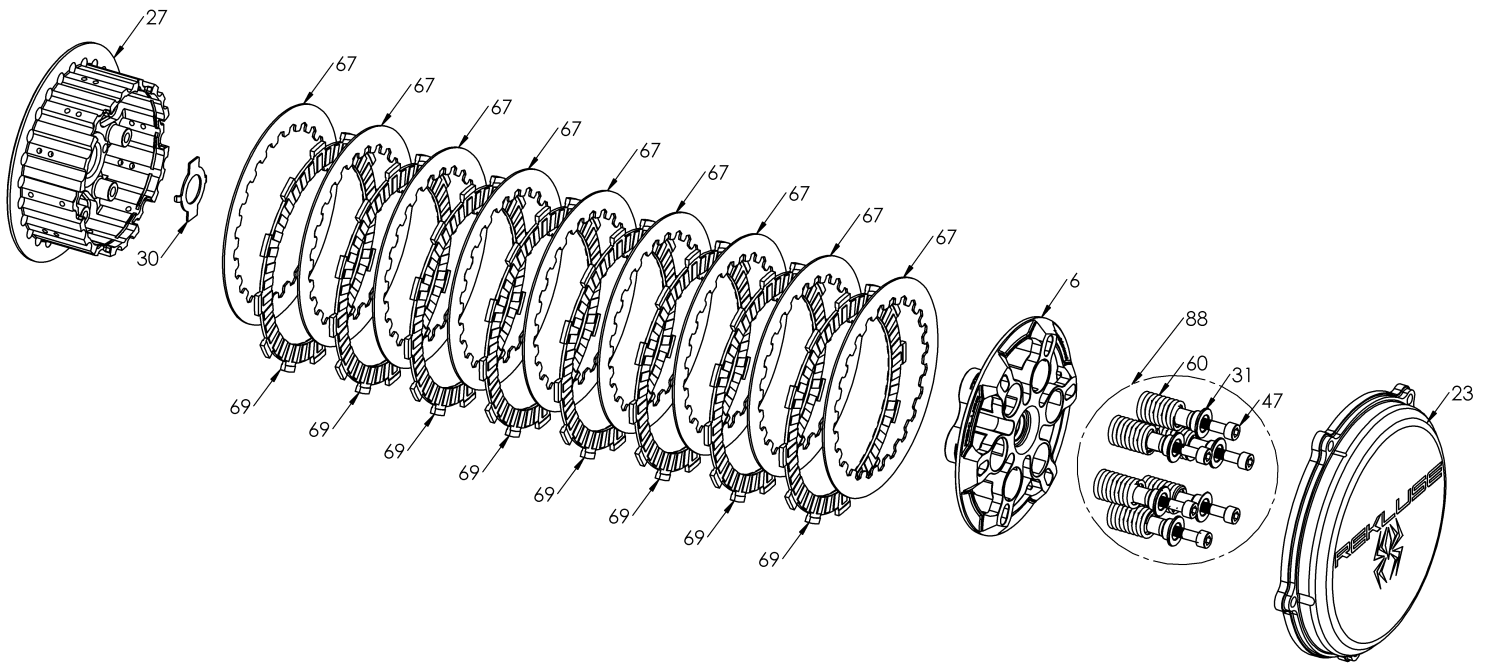

Item	Part Number	Item Description	Qty
6	114-217A	PRESSURE PLATE - CoreManual - GasGas 250,300 2T	1
23	169-902C	CLUTCH COVER - GAS GAS	1
27	178-117A	CENTER CLUTCH HUB - RadiusCX/Core - GasGas 250,300 2T	1
30	183-004A	HARDWARE - Core Center Clutch Tab Lock Washer 27mm S	1
67	465-481B	DRIVE PLATE - 0.048 zSP/Core RMS H450 Precision	9
69	469-013	FRICTION DISK - H450	8
88	744-010	CORE CLUTCH SPRING KIT - 450 - Medium (Red)	1
31	184-101B	HARDWARE - EXP Screw Sleeve	6
47	411-135	FASTENER - M6 x 40mm Socket Head Cap Screw	6
60	442-101	PRESSURE PLATE SPRING - 450 Class Bikes Medium Red (incl	6
Not Shown	780-091A	BRAKE TIP ASSEMBLY - GasGas Brake Tip with Installed Stud	1
Not Show	180-091A	BRAKE TIP - GASGAS	1
Not Show	411-185A	FASTENER - M3 x 0.5 x 12mm Flat-Tip Set Screw - 18-8	8
Not Show	411-186A	FASTENER - M5 x 0.8 x 12 Socket Head Screw - Zinc Plated -	2