

SHOWA

Ersatzteil-Liste
Extracross



FAHRWERKSTEILE VON SHOWA FINDEN

Komfortabel bestellen auf www.extracross.com

So geht's:

1.

Wählen Sie über das Menü die entsprechende Kategorie.

Hier z.B. Fahrwerk » Showa Originalteile » Showa Gabel Ersatzteile » Ersatzteile Showa SFF Air Gabel Ø 49mm » Ersatzteile Gabel Kawasaki KXF 450 15-16, Suzuki RMZ 450 15-17 (SFF AIR)

2.

ARTIKELNR.	BESCHREIBUNG	STÜCKZ.	VERF.	STÜCKZ.	VERF.
1	40000001 FORK TUBE	1	1	1	1
2	40000002 LOWER TUBE	1	1	1	1
3	40000003 LOWER SPRING	1	1	1	1
4	40000004 LOWER SPRING PLATE	1	1	1	1
5	40000005 LOWER SPRING PLATE	1	1	1	1
6	40000006 LOWER SPRING PLATE	1	1	1	1
7	40000007 LOWER SPRING PLATE	1	1	1	1
8	40000008 LOWER SPRING PLATE	1	1	1	1
9	40000009 LOWER SPRING PLATE	1	1	1	1
10	40000010 LOWER SPRING PLATE	1	1	1	1

Wählen Sie das Teil auf dem Foto.

suchen Sie in der ersten Spalte der Tabelle daneben die Nummer sowie das entsprechende Modell/Baujahr und klicken Sie auf das Feld.

3.

Der Artikel wird direkt in den Warenkorb gelegt

4.

Im Warenkorb sehen Sie die Verfügbarkeit und können die Stückzahl anpassen.

2009-2012 Ø47 Front Fork Parts List

SHOWA

	REFERENCE	NAME PART	QTY	09 CRF 250	09 KXF 250	10 KXF 250	09 RMZ 250	10 RMZ 250	11 RMZ 250	12 RMZ 250	09 RMZ 450	10 RMZ 450	11 RMZ 450	12 RMZ 450	
1	FJ6557301	OUTER TUBE	2		o	o									
1	FJ6556801	OUTER TUBE	2				o	o	o	o					
1	FJ6556701	OUTER TUBE	2								o	o	o	o	
2	F36600001	STOPPER RING	2	o	o	o	o	o	o	o	o	o	o	o	
3a	F30504701	R SLIDE PIPE Ø47 L597mm	2		o	o	o	o	o	o	o	o	o	o	
3a	F30504702	R SLIDE PIPE Ø47 L588mm	2	o											
4b	F44904703	R AXLE HOLDER	1	o											
3b	F44804703	L AXLE HOLDER	1	o											
3b	*NO NAME	L AXLE HOLDER	1		o	o									
4b	*NO NAME	R AXLE HOLDER	1		o	o									
4b	F44904702	R AXLE HOLDER	1				o	o	o	o	o	o	o	o	
3b	F44804702	L AXLE HOLDER	1				o	o	o	o	o	o	o	o	
5	F27604702	SLIDE BUSH	2	o	o	o	o	o	o	o	o	o	o	o	
6	F27504702	GUIDE BUSH	2	o	o	o	o	o	o	o	o	o	o	o	
7	F35300004	SEAL SPASER	2	o											
7	F35300003	SEAL SPASER	2		o	o	o	o	o	o	o	o	o	o	
8	F32004701	OIL SEAL	2	o	o	o	o	o	o	o	o	o	o	o	
9	F36500002	OIL SEAL STOPPER RING	2	o	o	o	o	o	o	o	o	o	o	o	
10	F33004701	DUST SEAL	2	o	o	o	o	o	o	o	o	o	o	o	

2009-2012 Ø47 Front Fork Parts List

	REFERENCE	NAME PART	QTY	09 CRF 250	09 KXF 250	10 KXF 250	09 RMZ 250	10 RMZ 250	11 RMZ 250	12 RMZ 250	09 RMZ 450	10 RMZ 450	11 RMZ 450	12 RMZ 450	
12	F27600001	SLIDE BUSH	2	o	o	o	o	o	o	o	o	o	o	o	
13	F75000001	SLAST LACE	2	o	o	o	o	o	o	o	o	o	o	o	
14a	F12041001	PISTON ROD COMP	2	o											
14a	F12041502	PISTON ROD COMP	2		o										
14a	F12041003	PISTON ROD COMP	2			o									
14a	F12040001	PISTON ROD COMP	2				o								
14a	F12040002	PISTON ROD COMP	2					o	o	o		o	o	o	
14a	F12040003	PISTON ROD COMP	2								o				
14b	F30140501	ROD PIPE L=405,5 mm Ø12,5mm	2	o	o	o									
14b	F30140001	ROD PIPE L=400 mm Ø12,5mm	2				o	o	o	o	o	o	o	o	
14c	F27800002	ROD END	2	o											
14c	*NO NAME	ROD END	2		o	o									
14c	F27800008	ROD END	2				o	o	o	o	o	o	o	o	
14d	F24022502	PISTON	2	o											
14d	F24000001	PISTON	2		o										
14d	F24022503	PISTON	2			o									
14d	F24022501	PISTON	2				o	o	o	o	o	o	o	o	
14e	F25002301	PISTON RING	2	o	o	o	o	o	o	o	o	o	o	o	
14f	F29900002	PUSH ROD	2	o	o	o									
14f	F29900004	PUSH ROD	2				o	o	o	o	o	o	o	o	
14g	F55100601	NUT	2	o	o	o	o	o	o	o	o	o	o	o	
15	F34512502	PACKING	2	o	o	o	o	o	o	o	o	o	o	o	
17	F34000018	O RING	2	o	o	o	o	o	o	o	o	o	o	o	



2009-2012 Ø47 Front Fork Parts List

SHOWA

	REFERENCE	NAME PART	QTY	09 CRF 250	09 KXF 250	10 KXF 250	09 RMZ 250	10 RMZ 250	11 RMZ 250	12 RMZ 250	09 RMZ 450	10 RMZ 450	11 RMZ 450	12 RMZ 450	
14	F27500001	GUIDE BUSH	2	o	o	o	o	o	o	o	o	o	o	o	
18	F20900002	OIL LOCK VALVE	2	o											
18	F20900001	OIL LOCK VALVE	2		o		o	o	o	o	o	o	o	o	
19	F36800002	STOPPER RING C	2	o	o		o	o	o	o	o	o	o	o	
20	F38500008	REBOUND SPG K=8.4N L=21.4mm	2	o	o	o	o	o	o	o	o	o	o	o	
21a	*NO NAME	FORK BOLT COMP	2	o											
21a	*NO NAME	FORK BOLT COMP	2		o	o									
21a	*NO NAME	FORK BOLT COMP	2				o	o	o	o	o	o	o	o	
21b	*NO NAME	FORK BOLT	2	o											
21b	*NO NAME	FORK BOLT	2		o	o									
21b	*NO NAME	FORK BOLT	2				o	o	o	o	o	o	o	o	
21c	F83910001	SHAFT	2	o											
21c	F83910002	SHAFT	2		o	o	o	o	o	o	o	o	o	o	
21	F34000006	O RING	2	o	o	o	o	o	o	o	o	o	o	o	
22	F45300001	PLUG BOLT	2	o	o	o	o	o	o	o	o	o	o	o	
23	F34000017	O RING	2	o	o	o	o	o	o	o	o	o	o	o	

2009-2012 Ø47 Front Fork Parts List

SHOWA

	REFERENCE	NAME PART	QTY	09 CRF 250	09 KXF 250	10 KXF 250	09 RMZ 250	10 RMZ 250	11 RMZ 250	12 RMZ 250	09 RMZ 450	10 RMZ 450	11 RMZ 450	12 RMZ 450	
24	F38100012	SPG B K=11,5 N/mm L=102,5 mm	2												
24	F38100013	SPG B K=14,2 N/mm L=102,5 mm	2												
24	F38100011	SPG B K=14,2 N/mm L=100 mm	2												
24	F38100007	SPG B K=16,1 N/mm L=100 mm	2												
24	F38100005	SPG B K=17,6 N/mm L=100 mm	2		o	o									
24	F38100006	SPG B K=19,0 N/mm L=100 mm	2				o	o	o	o	o	o	o	o	
24	F38100008	SPG B K=21,0 N/mm L=100 mm	2												
24	F38100002	SPG B K=17,3 N/mm L=100 mm	2	o											
24	F38100001	SPG B K=18,6 N/mm L=100 mm	2												
25	F57700001	SLAST WASHER	4	o	o	o	o	o	o	o	o	o	o	o	
26	FH7500001	GUIDE BUSH B	2	o											
27	F34000012	O RING	2	o											
28	F25003401	PISTON RING	2	o											
29	FK4501002	PACKING B	2	o											
30a	F86000001	FREE PISTON COMP	2	o											
30a	F86000005	FREE PISTON COMP	2		o	o	o	o	o	o	o	o	o	o	
30	FK7433401	SLID BUSH C	4		o	o	o	o	o	o	o	o	o	o	
31	F34000015	O RING	2		o	o	o	o	o	o	o	o	o	o	
32	F32201001	GAS SEAL	2		o	o	o	o	o	o	o	o	o	o	
33	F36600002	STOPPER RING	2		o	o	o	o	o	o	o	o	o	o	

2009-2012 Ø47 Front Fork Parts List

	REFERENCE	NAME PART	QTY	09 CRF 250	09 KXF 250	10 KXF 250	09 RMZ 250	10 RMZ 250	11 RMZ 250	12 RMZ 250	09 RMZ 450	10 RMZ 450	11 RMZ 450	12 RMZ 450	
34a	FL4000003	L PISTON	2	o				o	o	o		o	o	o	
34a	FL4000001	L PISTON	2		o	o	o				o				
34b	*NO NAME	ROD END B	2				o	o	o	o	o	o	o		
34b	F27A00002	ROD END B	2		o	o									
34b	*NO NAME	ROD END B	2	o											
34	F34000004	O RING	2	o	o	o	o	o	o	o	o	o	o	o	
35	F55100601	NUT,HEX	2	o	o	o	o	o	o	o	o	o	o	o	
36	F25002301	PISTON RING	2	o	o	o	o	o	o	o	o	o	o	o	
38	FB2600003	CENTER BOLT COMP	2	o	o	o	o	o	o	o	o	o	o	o	
37	F34000001	O RING	2	o	o	o	o	o	o	o	o	o	o	o	
39	F41000001	LOCK NUT	2	o	o	o	o	o	o	o	o	o	o	o	
40	F38004001	SPG K=4,0 N/mm L=493	2												
40	F38004101	SPG K=4,1 N/mm L=491	2												
40	F38004202	SPG K=4,2 N/mm L=494	2												
40	F38004301	SPG K=4,3 N/mm L=493	2												
40	F38004402	SPG K=4,4 N/mm L=494	2				o								
40	F38004501	SPG K=4,5 N/mm L=495	2		o	o									
40	F38004602	SPG K=4,6 N/mm L=494	2	o											
40	F38004702	SPG K=4,7 N/mm L=495	2				o			o					
40	F38004802	SPG K=4,7 N/mm L=496	2								o				
40	F38004901	SPG K=4,7 N/mm L=497	2												
40	F38004701	SPG K=4,61 N/mm L=495	2					o	o						
40	F38004801	SPG K=4,71 N/mm L=494	2									o	o		

	REFERENCE	NAME PART	QTY	11 KXF 250	12 KXF 250	
1	FJ6557501	OUTER TUBE	2	o	o	
2	F36600001	STOPPER RING	2	o		
2	F36600003	STOPPER RING	2		o	
3a	F30504706	R SLIDE PIPE Ø47	2	o	o	
4b	F44904704	R AXLE HOLDER	1	o	o	
3b	F44804704	L AXLE HOLDER	1	o	o	
5	F27604702	SLIDE BUSH	2	o	o	
6	F27504702	GUIDE BUSH	2	o	o	
7	F35300003	SEAL SPASER	2	o	o	
8	F32004701	OIL SEAL	2	o	o	
9	F36500002	OIL SEAL STOPPER RING	2	o	o	
10	F33004701	DUST SEAL	2	o	o	
14a	F12040801	PISTON ROD COMP	1	o	o	
14b	F30140801	ROD PIPE L=408mm Ø12.5mm	1	o	o	
14c	*NO NAME	ROD END	1	o	o	
14d	F24027501	PISTON	1	o	o	
14e	F25002801	PISTON RING	1	o	o	
14f	F29900002	PUSH ROD	1	o	o	
14g	F55100601	NUT,HEX	1	o	o	
15	F34512501	PACKING	1	o	o	
16	F35201801	BUCK UP RING	1	o	o	
17	F34000019	O RING	1	o	o	

	REFERENCE	NAME PART	QTY	11 KXF 250	12 KXF 250	
14	F27500001	GUIDE BUSH	1	o	o	
18	F20900004	OIL LOCK VALVE	1	o	o	
19	F36800001	STOPPER RING C	1	o	o	
20	F38500002	REB.SPG. K=21.6N/mm L=25.5mm R	1	o		
20	F38500003	REB.SPG. K=23.5N/mm L=60mm L	1	o		
20	F38500004	REB.SPG. K=11.1N/mm L=58.3mm R	1		o	
20	F38500005	REB.SPG. K=19.1N/mm L=28.1mm L	1		o	
21a	F15600004	FORK BOLT COMP	1	o	o	
21b	F45000002	FORK BOLT	1	o	o	
21c	F83910002	SHAFT	1	o	o	
14f	F29900002	PUSH ROD	2	o	o	
21	F34000006	O RING	1	o	o	
22	F45300001	PLUG BOLT	2	o	o	
23	F34000017	O RING	2	o	o	
24	F38100009	SPG B K=23.4 N/mm L=99 mm	1	o	o	
25	F57700001	SLAST WASHER	2	o	o	
27	F36800002	STOPPER RING B	1	o	o	
28	F75000001	SLAST LACE	1	o	o	
29	F34000014	O RING	1	o	o	
30	FK7433401	SLID BUSH C	2	o	o	
31	F34000015	O RING	1	o	o	
32	F32201001	GAS SEAL	1	o	o	
33	F36800002	STOPPER RING	1	o	o	

	REFERENCE	NAME PART	QTY	11 KXF 250	12 KXF 250	
34a	* NO NAME	L PISTON	1	o	o	
34b	F27A00002	ROD END B	1	o	o	
34	F34000004	O RING	1	o	o	
35	F55100601	NUT,HEX	2	o	o	
36	F25002801	PISTON RING	1	o	o	
38	FB2600003	CENTER BOLT COMP	1	o	o	
37	F34000001	O RING	2	o	o	
39	F41000001	LOCK NUT	1	o	o	
40	F38008701	SPRING K=8.7N/mm L=740 mm	1			
40	F38009101	SPRING K=9.1N/mm L=740 mm	1	o	o	
40	F38009501	SPRING K=9.5N/mm L=740 mm	1			
40	F38009901	SPRING K=9.9N/mm L=740 mm	1			
41a	F12A00001	TENSION ROD COMP	1	o	o	
41	F25002001	PISTON RING	1	o	o	
42	FB2600002	CENTER BOLT COMP	1	o	o	
43	F75300001	SLAST PLATE	1	o	o	
44	FR3700001	THRUST WASHER STOPPER RING	1	o	o	

	REFERENCE	NAME PART	QTY	10 CRF 250	11 CRF 250	12 CRF 250	13 CRF 250	14 CRF 250	
1	FJ6557101	OUTER TUBE	2	o	o	o	o	o	
2	F36600001	STOPPER RING	2	o	o	o	o	o	
3a	F30504801	R SLIDE PIPE Ø48 L=590mm	2	o	o	o	o	o	
4b	F44904801	R AXLE HOLDER	1	o	o	o	o	o	
3b	F44804801	L AXLE HOLDER	1	o	o	o			
3b	F44804802	L AXLE HOLDER	1				o	o	
5	F27604801	SLIDE BUSH	2	o	o	o	o	o	
6	F27504801	GUIDE BUSH	2	o	o	o	o	o	
7	F35300001	SEAL SPASER	2	o					
7	F35300002	SEAL SPASER	2		o	o	o	o	
8	F32004801	OIL SEAL	2	o	o	o	o	o	
9	F36500001	OIL SEAL STOPPER RING	2	o	o	o	o	o	
10	F33004801	DUST SEAL	2	o	o	o	o	o	

	REFERENCE	NAME PART	QTY	10 CRF 250	11 CRF 250	12 CRF 250	13 CRF 250	14 CRF 250
12	F27600002	SLIDE BUSH	2	°	°	°	°	°
13	F75300001	SLAST PLATE	2	°	°	°	°	°
14a	F12039601	PISTON ROD COMP	2	°				
14a	F12039602	PISTON ROD COMP	2		°	°	°	°
14b	F30139601	ROD PIPE L=396mm Ø12.5mm	2	°				
14b	F30139602	ROD PIPE L=396mm Ø12.5mm	2		°	°	°	°
14c	* NO NAME	ROD END	2	°				
14c	F27800001	ROD END	2		°	°	°	°
14d	F24002301	PISTON	2	°	°	°	°	°
14e	F25002401	PISTON RING	2	°	°	°	°	°
14f	F29900003	PUSH ROD	2	°	°	°	°	°
14g	F55100601	NUT	2	°	°	°	°	°
14	F27512001	GUIDE BUSH	2	°				
14	F27512501	GUIDE BUSH	2		°	°	°	°
15	F34512501	PACKING	2	°	°	°	°	°
16	F35201801	BUCK UP RING	2	°	°	°	°	°
17	F34000003	O RING	2	°	°	°	°	°
21a	F15600008	FORK BOLT COMP	2	°				
21a	F15600002	FORK BOLT COMP	2		°	°	°	°
21b	F45000005	FORK BOLT	2	°				
21b	F45000001	FORK BOLT	2		°	°	°	°
21c	F83900001	SHAFT	2	°				
21c	F83912701	SHAFT	2		°	°	°	°
21	F34000007	O RING Fork bolt top	2	°	°	°	°	°
21	F34000005	O RING Fork bolt inside	2	°				
22	F45300002	PLUG BOLT LONG	2	°				
23	F34000013	O RING	2	°				
22	F45300004	PLUG BOLT GOLD	2	°				
23	F34000017	O RING	2	°				
22	F45300003	PLUG BOLT	2		°	°	°	°
23	F34000017	O RING	2		°	°	°	°



	REFERENCE	NAME PART	QTY	10 CRF 250	11 CRF 250	12 CRF 250	13 CRF 250	14 CRF 250	
18	F20900003	OIL LOCK VALVE	2	○	○	○	○	○	
19	F36800002	STOPPER RING C	2	○	○	○	○	○	
20	F38500001	REB SPG K=0.7N/mm L=19mm	2	○	○	○	○	○	
27	F38100003	SPG B K=21.5N/mm L=105mm	2	○					
28	F40000001	SPG GUIDE	4	○					
27	F38100004	SPG B K=20.5N/mm L=96mm	2		○	○	○	○	
28	F40000001	SPG GUIDE	2		○	○	○	○	
24	F57700001	SLAST WASHER	2		○	○	○	○	
30a	F86000002	FREE PISTON COMP	2	○					
30a	F86000003	FREE PISTON COMP	2		○	○			
30a	F86000004	FREE PISTON COMP	2				○	○	
29	FK7333501	SLID BUSH B	2	○					
30	F34000016	O RING	4	○					
31	FS7700001	BUCKUP RING B	2	○					
29	FK7436901	SLID BUSH C	2	○					
29	FK7437601	SLID BUSH C	4		○	○	○	○	
30	F34000010	O RING	1		○	○	○	○	
31	F25003801	PISTON RING	1		○	○	○	○	
33	FK4501001	PACKING B	2	○	○	○	○	○	

	REFERENCE	NAME PART	QTY	10 CRF 250	11 CRF 250	12 CRF 250	13 CRF 250	14 CRF 250	
34a	FL4000002	L PISTON	2	o	o	o			
34a	FL4000004	L PISTON	2				o	o	
34b	* NO NAME	ROD END B	2	o					
34b	F27A00001	ROD END B	2		o	o	o	o	
34	F34000021	O RING	2	o	o	o			
34	F34000011	O RING	2				o	o	
35	F55100601	NUT,HEX	2	o	o	o	o	o	
36	F25002401	PISTON RING	2	o	o	o	o	o	
38	FB2600001	CENTER BOLT COMP	2	o	o	o	o	o	
37	F34000002	O RING	2	o	o	o	o	o	
39	F41000001	LOCK NUT	2	o	o	o	o	o	
40	F38004201	SPRING K=4.2N/mm L=460mm	2						
40	F38004401	SPRING K=4.4N/mm L=460mm	2	o	o	o			
40	F38004601	SPRING K=4.6N/mm L=460mm	2				o	o	

	REFERENCE	NAME PART	QTY	13-14	15-16	13-15	13-14	
				KXF 250	KXF 250	RMZ 250	RMZ 450	
1	FJ6556501	OUTER TUBE	2	o				
1	FJ6556504	OUTER TUBE	2		o			
1	FJ6556503	OUTER TUBE	2			o		
1	FJ6556502	OUTER TUBE	2				o	
2	F36600003	STOPPER RING	2	o	o			
2	F36600001	STOPPER RING	2			o	o	
3a	F30504803	R SLIDE PIPE Ø48 L=600mm	1	o	o			
4a	F30604801	L SLIDE PIPE Ø48 L=600mm	1	o	o			
4b	F44904802	R AXLE HOLDER	1	o	o			
3b	F44804803	L AXLE HOLDER	1	o	o			
3a	F30504805	R SLIDE PIPE Ø48 L=595mm	1			o		
4a	F30604802	L SLIDE PIPE Ø48 L=595mm	2			o	o	
4b	F44904805	R AXLE HOLDER	1			o	o	
3b	F44804806	L AXLE HOLDER	1			o	o	
3a	F30504804	R SLIDE PIPE Ø48 L=595mm	1				o	
5	F27604801	SLIDE BUSH	2	o	o	o	o	
6	F27504801	GUIDE BUSH	2	o	o	o	o	
7	F35300002	SEAL SPASER	2	o	o	o	o	
8	F32004802	OIL SEAL	2	o	o	o	o	
9	F36500001	OIL SEAL STOPPER RING	2	o	o	o	o	
10	F33004802	DUST SEAL	2	o	o	o	o	

	REFERENCE	NAME PART	QTY	13-14 KXF 250	15-16 KXF 250	13-15 RMZ 250	13-14 RMZ 450		
14a	F12039001	PISTON ROD COMP	1	o	o	o	o		
14b	F30139001	ROD PIPE L=390mm Ø12.5mm	1	o	o	o	o		
14c	F27800004	ROD END	1	o	o				
14c	F27800005	ROD END	1			o	o		
14d	F24003001	PISTON	1	o	o	o	o		
14e	F25003001	PISTON RING	1	o	o	o	o		
14f	F29900005	PUSH ROD	1	o	o	o	o		
14g	F55100601	NUT	1	o	o	o	o		
15	F34512501	PACKING	1	o	o	o	o		
16	F35201801	BUCK UP RING	1	o	o	o	o		
17	F34000020	O RING	1	o	o	o	o		
14	FH7500002	GUIDE BUSH B	2	o	o				
18	F20900005	OIL LOCK VALVE	1	o	o				
18	F20900006	OIL LOCK VALVE	1			o	o		
20	F38500006	REB. SPG. K=37.5N/mm L=21.1 mm SFFside	1	o	o	o	o		
20	F38500007	REB. SPG. K=47.1N/mm L=19.4 mm FF side	1	o	o	o	o		

	REFERENCE	NAME PART	QTY	13-14 KXF 250	15-16 KXF 250	13-15 RMZ 250	13-14 RMZ 450	
21a	F15600013	FORK BOLT COMP	1	o				
21a	F15600014	FORK BOLT COMP	1		o			
21a	F15600003	FORK BOLT COMP	1			o	o	
21b	F45000003	FORK BOLT	1	o				
21b	F45000007	FORK BOLT	1		o			
21b	F45000004	FORK BOLT	1			o	o	
21c	F83912901	SHAFT	1	o	o	o	o	
22	F45300003	PLUG BOLT	2	o	o	o	o	
23	F34000017	O RING	2	o	o	o	o	
21	F34000007	O RING	2	o	o	o	o	
24	F38100014	SPG B K=34,7 N/mm L=99	1				o	
25	F57700001	SLAST WASHER	1	o	o	o	o	
26	F40000002	SPG GUIDE	1	o	o	o	o	
27	F18621701	SPG COLLAR COMP	1	o	o			
27	F18621201	SPG COLLAR COMP	1			o	o	

	REFERENCE	NAME PART	QTY	13-14 KXF 250	15-16 KXF 250	13-15 RMZ 250	13-14 RMZ 450	
30a	F86000006	FREE PISTON COMP	1	○	○	○	○	
30	FK7437601	SLID BUSH C	4	○	○	○	○	
28	FK4501001	PACKING B	1	○	○	○	○	
31	F34000010	O RING	1	○	○	○	○	
32	F25003801	PISTON RING	1	○	○	○	○	
33	F29700001	DIAPHRAGM	1	○	○	○	○	
34a	<i>*NO NAME</i>	L PISTON	1	○	○	○	○	
34b	F27A00003	ROD END B	1	○	○			
34b	F27A00004	ROD END B	1			○	○	
34	F34000021	O RING	1	○	○	○	○	
35	F55100601	NUT,HEX	1	○	○	○	○	
36	F25003001	PISTON RING	1	○	○	○	○	

			QTY	13-14 KXF 250	15-16 KXF 250	13-15 RMZ 250	13-14 RMZ 450	
38	FB2600001	CENTER BOLT COMP	1	○	○	○	○	
37	F34000002	O RING	2	○	○	○	○	
39	F41000001	LOCK NUT	2	○	○	○	○	
40	F38009401	SPRING K=9,4 N/mm L=660	1	○				
40	F38009001	SPRING K=9,0 N/mm L=660	1	L				
40	F38009801	SPRING K=9,8 N/mm L=660	1	H				
40	F38009601	SPRING K=9,6 N/mm L=660	1		○			
40	F38009201	SPRING K=9,2 N/mm L=660	1		L			
40	F38010001	SPRING K=10,0 N/mm L=660	1		H			
40	F38009801	SPRING K=9,8 N/mm L=660	1			○	○	
40	F38009401	SPRING K=9,4 N/mm L=660	1			L	L	
40	F38010201	SPRING K=10,2 N/mm L=660	1			H	H	
41a	*NO NAME	TENSION ROD COMP	1	○	○	○	○	
41	F27800003	ROD END	1	○	○	○	○	
42	F25002301	PISTON RING	1	○	○	○	○	
43	FG1500001	CENTER BOLT	1	○		○	○	
43	FG1500002	CENTER BOLT	1		○			
44	F34000002	O RING	1	○	○	○	○	

L = light -0,4N/mm
H= heavy +0,4N/mm

REFERENCE	NAME PART	QTY	17 KXF 250
1	FJ6556501	OUTER TUBE	2
1	FJ6556504	OUTER TUBE	2
1	FJ6556503	OUTER TUBE	2
1	FJ6556502	OUTER TUBE	2
2	F36600003	STOPPER RING	2
2	F36600001	STOPPER RING	2
3a	F30504803	R SLIDE PIPE Ø48 L=600mm	1
4a	F30604801	L SLIDE PIPE Ø48 L=600mm	1
4b	F44904802	R AXLE HOLDER	1
3b	F44804803	L AXLE HOLDER	1
4a	F30604803	L SLIDE PIPE Ø48 L=	1
3a	F30504806	R SLIDE PIPE Ø48 L=	1
3a	F30504805	R SLIDE PIPE Ø48 L=595mm	1
4a	F30604802	L SLIDE PIPE Ø48 L=595mm	2
4b	F44904805	R AXLE HOLDER	1
3b	F44804806	L AXLE HOLDER	1
3a	F30504804	R SLIDE PIPE Ø48 L=595mm	1
5	F27604801	SLIDE BUSH	2
6	F27504801	GUIDE BUSH	2
7	F35300002	SEAL SPASER	2
8	F32004802	OIL SEAL	2
9	F36500001	OIL SEAL STOPPER RING	2
10	F33004802	DUST SEAL	2

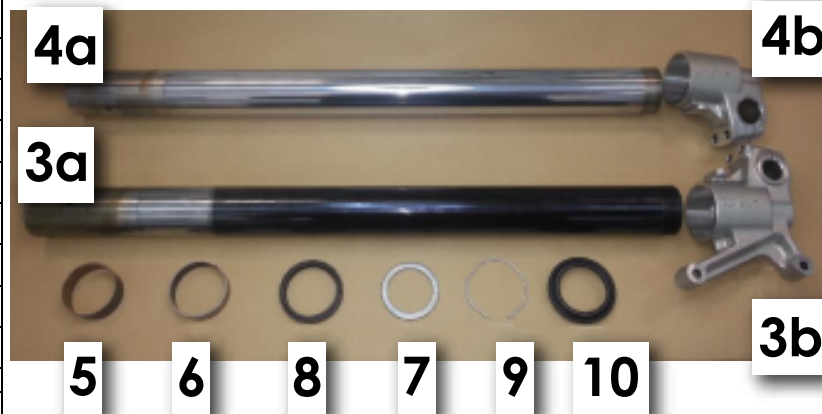

REFERENCE	NAME PART	QTY				17 KXF 250		
14a	F12039001	PISTON ROD COMP	1					
14a	F12000006	PISTON ROD COMP	1			○		
14b	F30139001	ROD PIPE L=390mm Ø12.5mm	1			○		
14c	F27800004	ROD END	1			○		
14c	F27800005	ROD END	1					
14d	F24003001	PISTON	1					
14d	F24003002	PISTON	1			○		
14e	F25003001	PISTON RING	1			○		
14f	F29900005	PUSH ROD	1			○		
14g	F55100601	NUT	1			○		
15	F34512501	PACKING	1			○		
16	F35201801	BUCK UP RING	1			○		
17	F34000020	O RING	1			○		
14	FH7500002	GUIDE BUSH B	2			○		
18	F20900005	OIL LOCK VALVE	1					
18	F20900006	OIL LOCK VALVE	1					
18	F20900007	OIL LOCK VALVE	1			○		
20	F38500006	REB. SPG. K=37.5N/mm L=21.1 mm SFFside	1			○		
20	F38500007	REB. SPG. K=47.1N/mm L=19.4 mm FF side	1			○		



REFERENCE	NAME PART	QTY	17 KXF 250			
21a	F15600013	FORK BOLT COMP	1			
21a	F15600014	FORK BOLT COMP	1			
21a	F15600003	FORK BOLT COMP	1			
21b	F45000003	FORK BOLT	1			
21b	F45000007	FORK BOLT	1			
21b	F45000014	FORK BOLT	1	○		
21b	F45000004	FORK BOLT	1			
21c	F83912901	SHAFT	1	○		
22	F45300003	PLUG BOLT	2	○		
23	F34000017	O RING	2	○		
21	F34000007	O RING	2	○		
24	F38100010	SPG K=27.9 N/mm L=99	1			
24	F38100009	SPG K=23.4 N/mm L=99	1	○		
24	F38100014	SPG B K=34,7 N/mm L=99	1			
25	F57700001	SLAST WASHER	1	○		

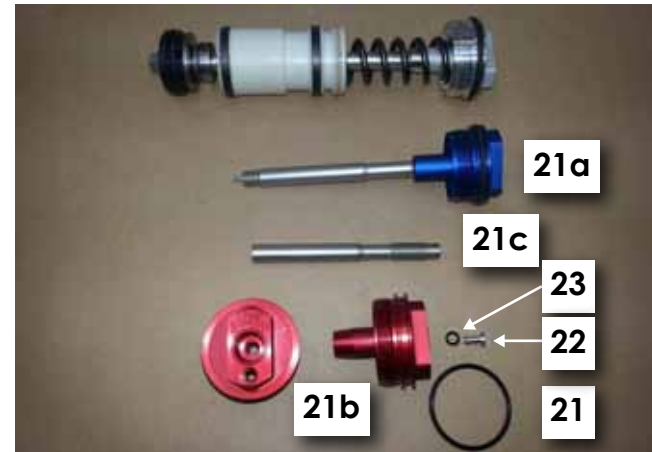

REFERENCE	NAME PART	QTY	17 KXF 250
26	F40000002	1	○
27	F18621701	1	○
27	F18621201	1	○
30a	F86000006	1	○
30	FK7437601	4	○
28	FK4501001	1	○
31	F34000010	1	○
32	F25003801	1	○
33	F29700001	1	○
34a	*NO NAME	1	○
34b	F27A00003	1	○
34b	F27A00004	1	○
34	F34000021	1	○
35	F55100601	1	○
36	F25003001	1	○

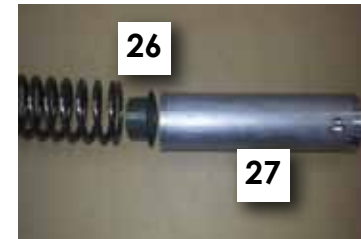

REFERENCE	NAME PART	QTY	17 KXF 250
38	FB2600001	1	○
37	F34000002	2	○
39	F41000001	2	○
40	F38009401	1	L
40	F38009001	1	
40	F38009801	1	○
40	F38009601	1	
40	F38009201	1	
40	F38010001	1	
40	F38009802	1	
40	F38009402	1	
40	F38010201	1	H
41α	*NO NAME	1	○
41	F27800003	1	○
42	F25002301	1	○
43	FG1500001	1	
43	FG1500002	1	○
44	F34000002	1	○

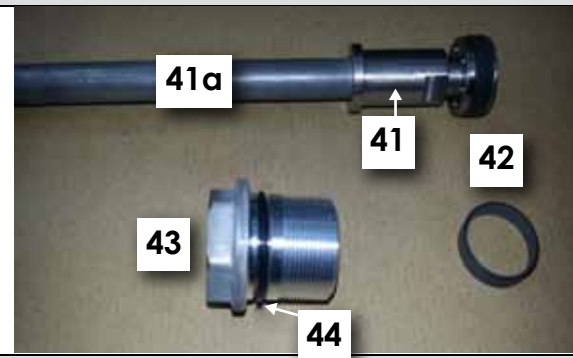
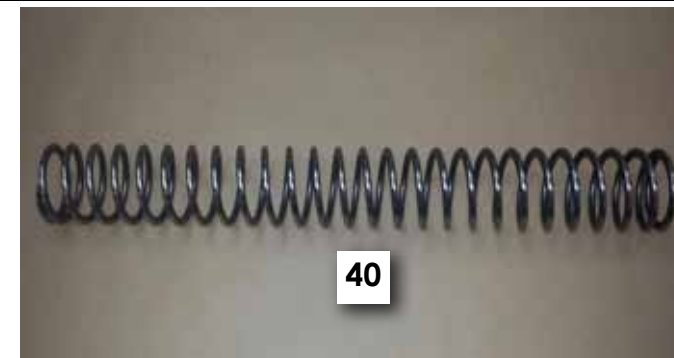

L = light -0,4N/mm
H = heavy +0,4N/mm

2015-17 Ø49 SFF-AIR Front Fork Parts List



	REFERENCE	NAME PART	QTY	15 CRF 250	16-17 CRF 250	
1	FJ6500001	OUTER TUBE	2	o		
1	FJ6500004	OUTER TUBE	2		o	
2	F36600004	STOPPER RING	2	o	o	
3	F30504901	R SLIDE PIPE Ø49 L=595mm	2	o		
3	F30504904	R SLIDE PIPE Ø49	2		o	
4b	F44804901	L AXLE HOLDER	1	o	o	
4	F44904901	R AXLE HOLDER	1	o	o	
5	F27604901	SLIDE BUSH	2	o	o	
6	F27504901	GUIDE BUSH	2	o	o	
7	F35300005	SEAL SPASER	2	o	o	
8	F32004901	OIL SEAL	2	o	o	
9	F36500003	OIL SEAL STOPPER RING	2	o	o	
10	F33004903	DUST SEAL	2	o	o	
11	F12500003	CYLINDER COMP	1	o		
11	F12500005	CYLINDER COMP	1		o	
12	F17700002	CYLINDER COMP B	1	o		
12	F17700003	CYLINDER COMP B	1		o	
13	F34000009	O RING	2	o	o	
14	F79800002	SEPARATER	2	o	o	
20	F38500009	REB.SPG. K=67N/mm L=17.4mm	1	o	o	
21	F39000001	REB.SPG.B K=127N/mm L=23.9mm	1	o	o	

2015-17 Ø49 SFF-AIR Front Fork Parts List



REFERENCE	NAME PART	QTY	15 CRF 250	16-17 CRF 250
17a	F12000001	PISTON ROD COMP	1	o
17a	F12000005	PISTON ROD COMP	1	o
17b	F30100002	ROD PIPE L=390mm Ø14mm	1	o
17c	F24003003	PISTON	1	o
17c	F24003004	PISTON	1	o
41	F25003001	PISTON RING	2	o
17d	F27800007	ROD END	1	o
17d	F27800009	ROD END	1	o
17e	F29900006	PUSH ROD	1	o
15	FH7500003	GUIDE BUSH B	2	o
16	F34000020	O RING	2	o
16	F34000020	O RING	1	o
17	FE9300001	ROD PACKING	1	o
17	FE9300002	ROD PACKING	1	o
18	FS0000001	BACK UP RING C	1	o
20	F20900005	OIL LOCK VALVE	1	o
20	F20900006	OIL LOCK VALVE	1	o
40	F55100601	NUT,HEX	1	o
23a	F15600007	FORK BOLT COMP	1	o
23a	F15600011	FORK BOLT COMP	1	o
23d	F45000006	FORK BOLT	1	o
23b	F83900002	SHAFT	1	o
23b	F83900003	SHAFT	1	o
23c	F27A00005	ROD END B	1	o
22	F45300001	PLUG BOLT	1	o
23	F34000017	O RING	1	o
24	F34000026	O RING	1	o
25	F57800001	WASHER	1	o
26	F38100015	SPG B K=22,8N/mm L=100mm	1	o
26	F38100017	SPG B K=32N/mm L=100mm	1	o
27	FL4000005	PISTON L	1	o
27b	F34000029	O RING	1	o
39	F55101201	NUT,HEX	1	o

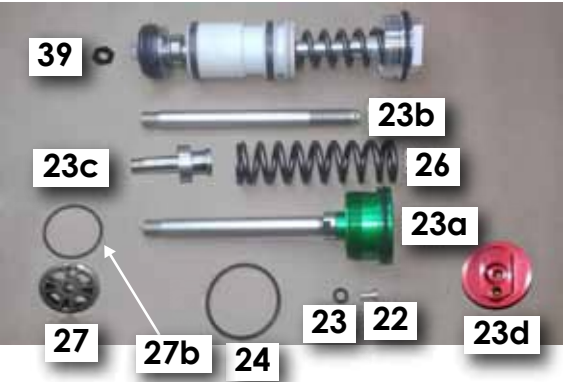

2015-17 Ø49 SFF-AIR Front Fork Parts List

SHOWA

	REFERENCE	NAME PART	QTY	15 CRF 250	16-17 CRF 250	
28	F86000007	FREE PISTON COMP	1	°	°	
28	F86000008	FREE PISTON COMP	1	°	°	
34	FK4500001	PACKING B	1	°	°	
35	F34000025	O RING	1	°	°	
36	F25200001	PISTON RING B	1	°	°	
37	FK7400001	SLID BUSH C	2	°	°	
42	FB2600004	CENTER BOLT COMP	1	°	°	
42	FB2600006	CENTER BOLT COMP	1	°	°	
43	F34000028	O RING	1	°	°	
44	F41000002	LOCK NUT	2	°	°	
45	F34000022	O RING	1	°	°	
46	F45600001	CAP,AIR VALVE	1	°	°	
47	FNGL00001	SEALING BOLT	1	°	°	
48	F34000004	O RING	1	°	°	
27	F34000024	O RING	2	°	°	
28	F46700001	AIR VALVE STEM	1	°	°	
28	F46700001	AIR VALVE STEM	2	°	°	
29	R46800001	AIR VALVE CORE	2	°	°	
29	R46800001	AIR VALVE CORE	3	°	°	
30	F15700001	AIR VALVE CAP COMP	1	°	°	
30	F15700001	AIR VALVE CAP COMP	2	°	°	
31	F45300005	PLUG BOLT	1	°	°	
32	F36700002	STOPPER RING B	1	°	°	

2015-17 Ø49 SFF-AIR Front Fork Parts List

SHOWA

	REFERENCE	NAME PART	QTY	15 CRF 250	16-17 CRF 250	
49	F12A00003	TENSION ROD COMP	1	○		
49	F12A00004	TENSION ROD COMP	1	○		
57	FE9100001	PISTON SEAL	1	○		
57	FE9100002	PISTON SEAL	1	○		
58	FYBC00001	PISTON PACKING B	1	○		
58	FYBC00002	PISTON PACKING B	1	○		
61	F25003001	PISTON RING	1	○	○	
50	F38300001	REBOUND SEAT	1	○		
50	F38300002	REBOUND SEAT	1	○		
51	FP6800001	OIL SEAL CASE B	1	○		
52	F35400001	OIL SEAL CASE	1	○		
52	F35400002	OIL SEAL CASE	1	○		
62	F34000020	O RING	2	○	○	
53	F34500001	PACKING	1	○	○	
54	F34500003	PACKING	1	○		
55	F34500002	PACKING	1	○		
56	F27000001	ROD GUIDE	1	○		
56	F27000002	ROD GUIDE	1	○		

2015-17 Ø49 SFF-AIR Front Fork Parts List



	REFERENCE	NAME PART	QTY	15 KXF 450	16 KXF 450	15-17 RMZ 450	
1	FJ6500001	OUTER TUBE	2	o	o		
1	FJ6500003	OUTER TUBE	2			o	
2	F36600004	STOPPER RING	2	o	o	o	
3	F30504902	R SLIDE PIPE Ø49 L=600mm	2	o			
3	F30504905	R SLIDE PIPE Ø49	2		o		
4b	F44804902	L AXLE HOLDER	1	o	o		
4	F44904902	R AXLE HOLDER	1	o	o		
3	F30504903	R SLIDE PIPE Ø49 L=595mm	2			o	
4	F44904903	R AXLE HOLDER	1			o	
4b	F44804903	L AXLE HOLDER	1			o	
5	F27604901	SLIDE BUSH	2	o	o	o	
6	F27504901	GUIDE BUSH	2	o	o	o	
7	F35300006	SEAL SPASER	2	o	o	o	
8	F32004901	OIL SEAL	2	o	o	o	
9	F36500003	OIL SEAL STOPPER RING	2	o	o	o	
10	F33004901	DUST SEAL	2	o	o		
10	F33004902	DUST SEAL	2			o	
11	F17700001	CYLINDER COMP B	2	o		o	
11	F17700004	CYLINDER COMP B	2		o		
12	F12500002	CYLINDER COMP	2	o			
12	F12500006	CYLINDER COMP	2		o		
12	F12500001	CYLINDER COMP	2			o	
13	F34000009	O RING	2	o	o	o	
14	F79800001	SEPARATER	2	o	o	o	
15	F38500009	REB SPG K=67N/mm L=17.4 mm	1	o		o	
15	F38500010	REB SPG K=140N/mm L=23.1 mm	1		o		
16	F39000001	REB SPG B K=127N/mm L=23.9mm	1	o		o	
16	F39000002	REB SPG B K=91N/mm L=31.4mm	1		o		

2015-17 Ø49 SFF-AIR Front Fork Parts List



	REFERENCE	NAME PART	QTY	15 KXF 450	16 KXF 450	15-17 RMZ 450	
17a	F12000002	PISTON ROD COMP	1	o			
17a	F12000004	PISTON ROD COMP	1		o		
17a	F12000003	PISTON ROD COMP	1			o	
17b	F30100001	ROD PIPE L=395 mm 14m	1	o	o	o	
17c	F24003002	PISTON	1	o		o	
17d	F27800007	ROD END	1	o			
17d	F27800010	ROD END	1		o		
17d	F27800006	ROD END	1			o	
17e	F29900005	PUSH ROD	2	o	o	o	
17	FH7500003	GUID BUSH B	2	o	o	o	
18	F34000020	O RING	1	o	o	o	
19	FE9300001	ROD PACKING	1	o		o	
19	FE9300002	ROD PACKING	1		o		
20	FS0000001	BACK UP RING C	1	o	o	o	
21	F20900007	OIL LOCK VALVE	1	o		o	
21	F20900006	OIL LOCK VALVE	1		o		
41	F25003001	PISTON RING	1	o	o	o	
40	F55100601	NUT,HEX	1	o	o	o	
23a	F15600005	FORK BOLT COMP	1			o	
23a	F15600006	FORK BOLT COMP	1	o			
23a	F15600012	FORK BOLT COMP	1		o		
23d	F45000008	FORK BOLT	1	o	o		
23d	F45000009	FORK BOLT	1			o	
23b	F83900002	SHAFT	1	o	o	o	
23c	F27A00007	ROD END B	1			o	
23c	F27A00006	ROD END B	1	o	o		
22	F45300001	PLUG BOLT	1	o	o		
23	F34000017	O RING	1	o	o		
24	F34000026	O RING	1	o	o		
27	F57800001	WASHER	1	o	o		
26	F38100016	SPG B K=28N/mm L=100 mm	1	o	o		
26	F38100014	SPG B K=34.7N/mm L=99 mm	1			o	
33	FL4000005	PISTON L	1	o	o	o	
33b	F34000029	O RING	1	o	o	o	
34	F55101201	NUT,HEX	1	o	o	o	

2015-17 Ø49 SFF-AIR Front Fork Parts List



	REFERENCE	NAME PART	QTY	15 KXF 450	16 KXF 450	15-17 RMZ 450	
28	F86000008	FREE PISTON COMP	1	○	○	○	
29	FK4500001	PACKING B	1	○	○	○	
30	F34000025	O RING	1	○	○	○	
31	F25200001	PISTON RING B	1	○	○	○	
32	FK7400001	SLID BUSH C	1	○	○	○	
37	FB2600005	CENTER BOLT COMP	1	○	○	○	
38	F34000028	O RING	1	○	○	○	
22	F41000002	LOCK NUT	2	○	○	○	
39	F34000022	O RING	1	○	○	○	
40	FNGL00002	SEALING BOLT	1	○	○	○	
41	F34000004	O RING	1	○	○	○	
42	F34000027	O RING	1	○	○	○	
43	F34000024	O RING	3	○	○	○	
44	F46700001	AIR VALVE STEM	3	○	○	○	
45	R46800001	AIR VALVE CORE	3	○	○	○	
46	F36700002	STOPPER RING B	1	○	○	○	
46b	F34000034	O RING	1	○	○	○	
46c	F34000030	O RING	1	○	○	○	
60	F15700001	AIR VALVE CAP COMP	2	○	○	○	

2015-17 Ø49 SFF-AIR Front Fork Parts List



	REFERENCE	NAME PART	QTY	15 KXF 450	16 KXF 450	15-17 RMZ 450	
47	F38300001	REBOUND SEAT	1	o		o	
47	F38300002	REBOUND SEAT	1		o		
48	F35400001	OIL SEAL CASE	1	o		o	
48	F35400002	OIL SEAL CASE	1		o		
49	F34000020	O RING	2	o		o	
49	F34000020	O RING	1		o		
50	F34500001	PACKING	1	o	o	o	
51	F34500003	PACKING	1	o		o	
52	F34500002	PACKING	1	o		o	
53	FP6800001	OIL SEAL CASE B	1	o		o	
54	F27000001	ROD GUIDE	1	o		o	
54	F27000003	ROD GUIDE	1		o		
55	F12A00002	TENSION ROD COMP	1	o		o	
55	F12A00005	TENSION ROD COMP	1		o		
56	FE9100001	PISTON SEAL	1	o		o	
56	FE9100002	PISTON SEAL	1		o		
57	FYBC00001	PISTON PACKING B	1	o		o	
57	FYBC00002	PISTON PACKING B	1		o		
61	F25003001	PISTON RING	1	o	o	o	
58	FB3200001	PLUG BOLT COMP	1	o		o	
58	FB3200003	PLUG BOLT COMP	1		o		
58	FB3200002	PLUG BOLT COMP	1			o	
59	F45600002	PLUG BOLT COMP	1	o	o	o	

2017 KXF450 Ø49 SFF Front Fork Parts List



	REFERENCE	NAME PART	QTY	17 KXF 450	
1	FJ6500005	OUTER TUBE	2	○	
2	F36600004	STOPPER RING	2	○	
3	F30504905	R SLIDE PIPE Ø49	2	○	
4b	F44804902	L AXLE HOLDER	1	○	
4	F44904902	R AXLE HOLDER	1	○	
5	F27604901	SLIDE BUSH	2	○	
6	F27504901	GUIDE BUSH	2	○	
7	F35300006	SEAL SPASER	2	○	
8	F32004901	OIL SEAL	2	○	
9	F36500003	OIL SEAL STOPPER RING	2	○	
10	F33004901	DUST SEAL	2	○	
11	F17700005	CYLINDER COMP B	2	○	
12	F12500007	CYLINDER COMP	2	○	
13	F34000009	O RING	2	○	
14	F79800003	SEPARATER	2	○	
15	F38500012	REB SPG K=138N/mm L=23 mm	1	○	
16	F39000003	REB SPG B K=87.3N/mm L=31.4mm	1	○	
17a	F12000008	PISTON ROD COMP	1	○	
17b	F30100003	ROD PIPE L= mm 14mm	1	○	
17c	F24000002	PISTON	1	○	
17d	F27800012	ROD END	1	○	
17e	F29900007	PUSH ROD	2	○	
17	FH7500003	GUID BUSH B	2	○	
18	F34000020	O RING	1	○	
19	FE9300002	ROD PACKING	1	○	
21	F20900006	OIL LOCK VALVE	1	○	
41	F25003101	PISTON RING	1	○	
40	F55100801	NUT, HEX	1	○	

2017 KXF450 Ø49 SFF Front Fork Parts List *SHOWA*

	REFERENCE	NAME PART	QTY	17 KXF 450			
	23d	F45000015	FORK BOLT	1	○	<p>This photograph shows various components of the front fork assembly. Part 34 is a large fork bolt with a spring. Part 23b is a shaft. Part 23c is a rod end with a spring. Part 26 is a spring. Part 23a is a green bush. Part 23d is a red nut. Part 24 is a washer. Part 23 is a plug bolt. Part 22 is a lock nut. Part 33 is a piston L. Part 33b is an O-ring. Part 24 is a seal spacer.</p>	
	23b	F83900004	SHAFT	1	○		
	23c	F27A00009	ROD END B	1	○		
	22	F45300001	PLUG BOLT	1	○		
	23	F34000017	O RING	1	○		
	24	F34000026	O RING	1	○		
	27	F57800001	WASHER	1	○		
	26	F38100016	SPG B K=28N/mm L=100 mm	1	○		
	33	FL4000006	PISTON L	1	○		
	33b	F34000035	O RING	1	○		
	34	F55100801	NUT,HEX	1	○		
	28	F86000009	FREE PISTON COMP	1	○		<p>This photograph shows the free piston components. Part 28 is the free piston assembly. Part 32 is a gas seal. Part 30 is an O-ring. Part 31 is a piston ring B. Part 32 is a slid bush C. Part 29 is a stopper ring.</p>
	29	F32200001	GAS SEAL	1	○		
	30	F34000012	O RING	1	○		
	31	F25003401	PISTON RING B	1	○		
	32	FK7433601	SLID BUSH C	2	○		
	35	F36600005	STOPPER RING	1	○		
	36	F35300008	SEAL SPACER	1	○		
	37	FB2600004	CENTER BOLT COMP	1	○	<p>This photograph shows the center bolt components. Part 22 is a lock nut. Part 37 is the center bolt assembly. Part 38 is an O-ring.</p>	
	38	F34000028	O RING	1	○		
	22	F41000002	LOCK NUT	2	○		
	39	F34000022	O RING	1	○	<p>This photograph shows the sealing bolt components. Part 39 is an O-ring. Part 22 is a lock nut. Part 40 is the sealing bolt assembly. Part 41 is an O-ring. Part 42 is an O-ring.</p>	
	40	FNGL00002	SEALING BOLT	1	○		
	41	F34000004	O RING	1	○		
	42	F34000027	O RING	1	○		

2017 KXF450 Ø49 SFF Front Fork Parts List **SHOWA**

REFERENCE	NAME PART	QTY	17 KXF 450	
43	F34000024	O RING	3	
44	F46700001	AIR VALVE STEM	3	
45	R46800001	AIR VALVE CORE	3	
46	F36700002	STOPPER RING B	1	
46b	F34000034	O RING	1	
46c	F34000030	O RING	1	
60	F15700001	AIR VALVE CAP COMP	2	
47	F38300003	REBOUND SEAT	1	
48	F35400003	OIL SEAL CASE	1	
49	F34000035	O RING	1	
50	F34500001	PACKING	1	
52	FE9300002	ROD PACKING	1	
54	F27000004	ROD GUIDE	1	
55	F12A00006	TENSION ROD COMP	1	
56	FE9100003	PISTON SEAL	1	
57	FYBC00003	PISTON PACKING B	1	
61	n/a	PISTON RING	1	
58	FB3200003	PLUG BOLT COMP	1	
59	F45600002	PLUG BOLT COMP	1	

	REFERENCE	NAME PART	QTY	17 CRF /CRFX 450	
1	FJ6500006	OUTER TUBE	2	○	
2	F36600004	STOPPER RING	2	○	
3	F30504906	R SLIDE PIPE Ø49 L= mm	2	○	
4	F44904901	R AXLE HOLDER	1	○	
4B	F44804904	L AXLE HOLDER	1	○	
5	F27604901	SLIDE BUSH	2	○	
6	F27504901	GUIDE BUSH	2	○	
7	F35300005	SEAL SPASER	2	○	
8	F32004901	OIL SEAL	2	○	
9	F36500003	OIL SEAL STOPPER RING	2	○	
10	F33004903	DUST SEAL	2	○	
11	F12500008	CYLINDER COMP B (CRF450)	2	○	
11	F12500009	CYLINDER COMP B (CRF450X)	2	○	
20	F38500011	REB.SPG. K=71.5N/mm L=11.8mm	2	○	
17a	F12000009	PISTON ROD COMP (CRF450)	2	○	
17a	F12000010	PISTON ROD COMP (CRFX450)	2	○	
17b	F30100002	ROD PIPE L=390mm Ø14mm	2	○	
17c	F24002501	PISTON	2	○	
41	F25002501	PISTON RING	2	○	
17d	F27800011	ROD END	2	○	
17e	F29900006	PUSH ROD	2	○	
15	F27501401	GUIDE BUSH B	2	○	
16	F34000003	O RING	2	○	
17	FE9300001	ROD PACKING	2	○	
18	FS0000001	BACK UP RING C	2	○	
20	F20900008	OIL LOCK VALVE	2	○	
40	F55100601	NUT,HEX	2	○	

	REFERENCE	NAME PART	QTY	17 CRF /CRFX 450		
23d	F45000013	FORK BOLT (CRF450)	2	○		
23d	F45000016	FORK BOLT (CRFX450)	2	○		
23b	F83900002	SHAFT	2	○		
23c	F27A00008	ROD END B	2	○		
22	F45300001	PLUG BOLT	2	○		
23	F34000017	O RING	2	○		
24	F34000026	O RING	2	○		
25	F57800001	WASHER	2	○		
26	F38100018	SPG B K=22,6N/mm L=100mm (CRF450)	2	○		
26	F38100019	SPG B K=21,5N/mm L=100mm(CRF450)	2	○		
27	FL4000005	PISTON L	2	○		
27b	F34000029	O RING	2	○		
39	F55101201	NUT,HEX	2	○		
28	F86000008	FREE PISTON COMP	1	○		
34	FK4500001	PACKING B	1	○		
35	F34000025	O RING	1	○		
36	F25200001	PISTON RING B	1	○		
37	FK7400001	SLID BUSH C	2	○		
42	FB2600006	CENTER BOLT COMP	1	○		
43	F34000028	O RING	1	○		
44	F41000002	LOCK NUT	2	○		
40	F38004605	SPRING K=4,6N/mm L=472mm	2	L		
40	F38004804	SPRING K=4,8N/mm L=472mm	2	○		
40	F38005002	SPRING K=5,0N/mm L=472mm	2	H		

L = light -0,4N/mm
H= heavy +0,4N/mm

2009-2017 Rear Cushion-Parts List



	REFERENCE	NAME PART	QTY	CRF 250												KXF 250		
				09	10	11	12	13	14	15	16-17	09	10	11	12-17			
1	R55101601	NUT,HEX	1															
1	R55101401	NUT,HEX	1	o	o	o	o	o	o	o	o	o	o	o	o	o	o	o
2	R25005001	PISTON RING	1	o	o	o	o	o	o					o	o	o	o	
2a	R24005001	PISTON	1															
2a	R24005002	PISTON	1											o	o	o	o	
2a	R24005003	PISTON	1	o	o	o	o	o	o	o	o	o	o					
2a	R24005004	PISTON	1															
37	R34505001	PACKING	1															
38	R35205001	BUCK UP RING	2															
39	R25005002	PISTON RING	1															
39	R25005002	PISTON RING	2															
3	R34005001	O RING	2	o	o	o	o	o	o	o	o	o	o	o	o	o	o	
5	R26901601	OIL SEAL GUIDE	1	o	o	o	o	o	o	o	o	o	o	o	o	o	o	
6	R33001601	DUST SEAL	1	o	o	o	o	o	o	o	o	o	o	o	o	o	o	
7	R27501601	GUIDE BUSH	1	o	o	o	o	o	o	o	o	o	o	o	o	o	o	
4	R32001601	OIL SEAL	1	o	o	o	o	o	o	o	o	o	o	o	o	o	o	
4	R32001801	OIL SEAL	1															
4a	R35201801	BUCK UP RING	1															
5	R26901801	OIL SEAL GUIDE	1															
6	R33001801	DUST SEAL	1															
7	R27501801	GUIDE BUSH	1															
8	R38800001	REBOUND RUBBER	1	o														
8	R38800002	REBOUND RUBBER	1		o	o	o	o	o	o	o	o	o	o	o	o	o	
9	R34005002	O RING	1	o	o	o	o	o	o	o	o	o	o	o	o	o	o	
10	R36600001	STOPPER RING	1	o	o	o	o	o	o	o	o	o	o	o	o	o	o	
40	R38502301	REBOUND SPG L=23mm	1	o														
40	R38502302	REBOUND SPG L=23mm	1		o	o	o	o	o	o	o	o	o	o	o	o	o	
40	R38502701	REBOUND SPG L=27mm	1											o	o	o	o	
41	R27301602	ROD GUIDE CASE	1	o	o	o	o	o	o	o	o	o	o	o	o	o	o	
41	R27301601	ROD GUIDE CASE	1											o	o	o	o	
41	R27301801	ROD GUIDE CASE	1															
11	R41501601	STOPPER RUBBER	1	o	o	o	o	o	o	o	o	o	o	o	o	o	o	
11	R41501602	STOPPER RUBBER	1															
11	R41501801	STOPPER RUBBER	1															



2009-2017 Rear Cushion-Parts List

	REFERENCE	NAME PART	QTY	09	10	11	12	13	14	15	16	17	09	10	11	12	16	17
				CRF 250								KXF 250						
12a	RB3200001	PLUG BOLT COMP	1															
12a	RB3200002	PLUG BOLT COMP	1															
12a	RB3200003	PLUG BOLT COMP	1															
12a	RB3200004	PLUG BOLT COMP	1															
12a	RB3200005	PLUG BOLT COMP	1															
12a	RB3200006	PLUG BOLT COMP	1		o	o	o	o	o	o								
20	RB3200007	PLUG BOLT COMP	1	o														
12a	RB3200008	PLUG BOLT COMP	1															
12a	RB3200009	PLUG BOLT COMP	1										o	o				
12a	RB3200010	PLUG BOLT COMP	1											o	o			
12a	RB3200011	PLUG BOLT COMP	1									o						
12a	RB3200012	PLUG BOLT COMP	1														o	
12a	RB3200013	PLUG BOLT COMP	1															o
12	R34000001	O RING	1	o	o	o	o	o	o	o	o	o	o	o	o	o	o	o
13	R34000002	O RING	1	o	o	o	o	o	o	o	o	o	o	o	o	o	o	o
14	R36700001	STOPPER RING B	1	o	o	o	o	o	o	o	o	o	o	o	o	o	o	o
15	R34000003	O RING	1															
17	R36600002	STOPPER RING	1															
18	R55100601	NUT,HEX	1	o	o	o	o	o	o	o	o	o	o	o	o	o	o	o
19	R29606001	BLADDER	1		o	o	o	o	o	o	o							
22	R36600003	STOPPER RING	1		o	o	o	o	o	o	o							
19	R29610502	BLADDER	1										o	o	o	o		
19	R29610301	BLADDER	1															
20a	R45500001	AIR VALVE	1	o	o	o	o	o	o	o	o	o	o	o	o	o	o	o
20	R46800001	AIR VALVE CORE	1	o	o	o	o	o	o	o	o	o						
21	R15700001	AIR VALVE CAP COMP	1	o	o	o	o	o	o	o	o	o						
22	R36600004	STOPPER RING	1	o									o					
22a	RB0600001	CHAMBER CAP COMP	1		o	o	o	o	o	o	o							
22a	R60700001	CHAMBER CAP COMP	1	o									o	o	o	o		
22a	RB0600002	CHAMBER CAP COMP	1											o	o	o	o	
22a	RB0600003	CHAMBER CAP COMP	1															
22a	RB0600004	CHAMBER CAP COMP	1															
22a	RB0600005	CHAMBER CAP COMP	1															
23	R47500001	SPHERICAL BEARING	1	o	o	o	o	o	o	o	o							
24	R36600005	STOPPER RING	1	o	o	o	o	o	o	o	o							
25	0	DUST SEAL	1	o	o	o	o	o	o	o	o	o						
26	0	DUST SEAL	1	o	o	o	o	o	o	o	o	o						
27	R75100001	NEEDL BEARING	1										o	o	o	o		o
27	R75100002	NEEDL BEARING	1															
29	R33000003	DUST SEAL	2															
30	R50800001	COLLAR	1															
31	RR8000004	COLLAR B	1															





2009-2017 Rear Cushion-Parts List

	REFERENCE	NAME PART	QTY	CRF 250							KXF 250								
				09	10	11	12	13	14	15	16-17	09	10	11	12-16	17			
47	R12201601	JOINT ROD COMP	1	○															
47	R12201602	JOINT ROD COMP	1		○														
47	R12201603	JOINT ROD COMP	1			○	○	○											
47	R12201604	JOINT ROD COMP	1						○	○	○								
47	R12201605	JOINT ROD COMP	1									○	○	○					
47	R12201606	JOINT ROD COMP	1													○	○		
47	R12201607	JOINT ROD COMP	1																
47	R12201608	JOINT ROD COMP	1																
47	R12201609	JOINT ROD COMP	1																
47	R12201801	JOINT ROD COMP	1																
47	R12201802	JOINT ROD COMP	1																
47	R12201803	JOINT ROD COMP	1																
47b	R30001601	ROD Ø16 L257mm	1	○		○	○	○	○	○	○					○	○		
47b	R30001602	ROD Ø16 L257mm	1		○														
47b	R30001603	ROD Ø16 L254mm	1										○	○	○				
47b	R30001801	ROD Ø18 L250mm	1																
47b	R30001802	ROD Ø18 L248mm	1																
47b	R30001803	ROD Ø18 L254mm	1																
47c	R41001601	LOCK NUT Ø16	1	○	○	○	○	○	○	○	○		○	○	○	○	○	○	○
47c	R41001801	LOCK NUT Ø18	1																
47d	R34000004	O RING	1																
47e	R29900003	PUSH ROD	1	○	○	○	○	○	○	○	○								
47e	R29900004	PUSH ROD	1																
47e	R29900005	PUSH ROD	1													○	○		
47e	R29900006	PUSH ROD	1																
47e	R29900007	PUSH ROD	1																

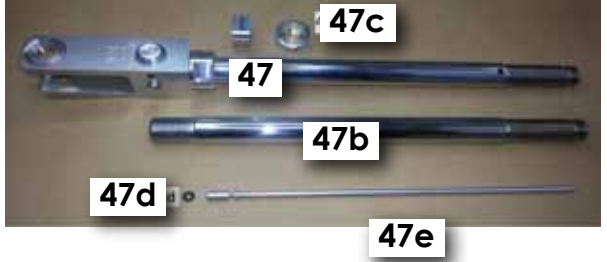

2009-2017 Rear Cushion-Parts List

SHOWA

	REFERENCE	NAME PART	QTY	15	16	09	10	11	13	09	10	11	13	14	15	
				KXF450	RMZ 250	RMZ 450	12	15	12	15	17					
1	R55101601	NUT,HEX	1													
1	R55101401	NUT,HEX	1													
2	R25005001	PISTON RING	1													
2a	R24005001	PISTON	1													
2a	R24005002	PISTON	1													
2a	R24005003	PISTON	1													
2a	R24005004	PISTON	1													
37	R34505001	PACKING	1													
38	R35205001	BUCK UP RING	2													
39	R25005002	PISTON RING	1													
39	R25005002	PISTON RING	2													
3	R34005001	O RING	2													
5	R26901601	OIL SEAL GUIDE	1													
6	R33001601	DUST SEAL	1													
7	R27501601	GUIDE BUSH	1													
4	R32001601	OIL SEAL	1													
4	R32001801	OIL SEAL	1													
4a	R35201801	BUCK UP RING	1													
5	R26901801	OIL SEAL GUIDE	1													
6	R33001801	DUST SEAL	1													
7	R27501801	GUIDE BUSH	1													
8	R38800001	REBOUND RUBBER	1													
8	R38800002	REBOUND RUBBER	1													
9	R34005002	O RING	1													
10	R36600001	STOPPER RING	1													
40	R38502301	REBOUND SPG L=23mm	1													
40	R38502302	REBOUND SPG L=23mm	1													
40	R38502701	REBOUND SPG L=27mm	1													
41	R27301602	ROD GUIDE CASE	1													
41	R27301601	ROD GUIDE CASE	1													
41	R27301801	ROD GUIDE CASE	1													
11	R41501601	STOPPER RUBBER	1													
11	R41501602	STOPPER RUBBER	1													
11	R41501801	STOPPER RUBBER	1													



2009-2017 Rear Cushion-Parts List

	REFERENCE	NAME PART	QTY	15	16	17	09	10	11	13	09	10	11	13	14	15	17
				KXF450	RMZ 250	RMZ 450											
12a	RB3200001	PLUG BOLT COMP	1								o						
12a	RB3200002	PLUG BOLT COMP	1								o	o					
12a	RB3200003	PLUG BOLT COMP	1						o					o	o	o	o
12a	RB3200004	PLUG BOLT COMP	1				o										
12a	RB3200005	PLUG BOLT COMP	1				o	o									
12a	RB3200006	PLUG BOLT COMP	1														
20	RB3200007	PLUG BOLT COMP	1														
12a	RB3200008	PLUG BOLT COMP	1														
12a	RB3200009	PLUG BOLT COMP	1														
12a	RB3200010	PLUG BOLT COMP	1	o	o												
12a	RB3200011	PLUG BOLT COMP	1														
12a	RB3200012	PLUG BOLT COMP	1														
12a	RB3200013	PLUG BOLT COMP	1			o											
12	R34000001	O RING	1	o	o	o	o	o	o	o	o	o	o	o	o	o	o
13	R34000002	O RING	1	o	o	o											
14	R36700001	STOPPER RING B	1	o	o	o											
15	R34000003	O RING	1				o	o	o	o	o	o	o	o	o	o	o
17	R36600002	STOPPER RING	1				o	o	o	o	o	o	o	o	o	o	o
18	R55100601	NUT,HEX	1	o	o	o	o	o	o	o	o	o	o	o	o	o	o
19	R29606001	BLADDER	1														
22	R36600003	STOPPER RING	1														
19	R29610502	BLADDER	1	o	o	o		o	o	o		o	o	o	o	o	o
19	R29610301	BLADDER	1				o				o						
20a	R45500001	AIR VALVE	1	o	o	o	o	o	o	o	o	o	o	o	o	o	o
20	R46800001	AIR VALVE CORE	1				o	o	o	o	o	o	o	o	o	o	o
21	R15700001	AIR VALVE CAP COMP	1				o	o	o	o	o	o	o	o	o	o	o
22	R36600004	STOPPER RING	1				o	o	o	o	o	o	o	o	o	o	o
22a	RB0600001	CHAMBER CAP COMP	1														
22a	R60700001	CHAMBER CAP COMP	1														
22a	RB0600002	CHAMBER CAP COMP	1	o	o	o											
22a	RB0600003	CHAMBER CAP COMP	1				o	o	o		o	o	o	o	o	o	o
22a	RB0600004	CHAMBER CAP COMP	1							o							
22a	RB0600005	CHAMBER CAP COMP	1				o										
23	R47500001	SPHERICAL BEARING	1														
24	R36600005	STOPPER RING	1														
25	0	DUST SEAL	1														
26	0	DUST SEAL	1														
27	R75100001	NEEDL BEARING	1	o	o	o											
27	R75100002	NEEDL BEARING	1				o	o	o	o	o	o	o	o	o	o	o
29	R33000003	DUST SEAL	2				o	o	o	o	o	o	o	o	o	o	o
30	R50800001	COLLAR	1				o	o	o	o	o	o	o	o	o	o	o
31	RR8000004	COLLAR B	1				o	o	o	o	o	o	o	o	o	o	o



2009-2017 Rear Cushion-Parts List

	REFERENCE	NAME PART	QTY	15	16	17	09	10	11-	13-	09	10	11-	13	14	13-	17
				KXF450													
				RMZ 250				RMZ 450									
32	RF6300001	SPG ADJ NUT	1				o	o	o		o	o	o				
33	R39100001	SPG ADJ	1				o	o	o		o	o	o				
32	RF6300002	SPG ADJ NUT	1	o	o	o				o				o	o	o	o
33	R39100002	SPG ADJ	1	o	o	o				o				o	o	o	o
32	RF6300003	SPG ADJ NUT	1														
33	R39100003	SPG ADJ	1														
34	R39300001	SPG SEAT B	1	o	o	o	o	o	o	o	o	o	o	o	o	o	o
35	R36800001	STOPPER RING C	1	o	o	o	o	o	o	o	o	o	o	o	o	o	o
36	R38005001	SPRING 49N/mm	1														
36	R38005101	SPRING 50N/mm	1														
36	R38005201	SPRING 51 N/mm	1														
36	R38005301	SPRING 52N/mm	1														
36	R38005402	SPRING 53N/mm	1				o										
36	R38005501	SPRING 54N/mm	1							o							
36	R38005601	SPRING 55N/mm	1							o							
36	R38005701	SPRING 56/Nmm	1				o	o									
36	R38005801	SPRING 57N/mm	1							o	o						
36	R38005502	SPRING 54N/mm	1							o							
36	R38005702	SPRING 56N/mm	1										o	o	o		
36	R38005802	SPRING 57/Nmm	1														
36	R38005901	SPRING 58N/mm	1														
36	R38005302	SPRING 52N/mm	1														
36	R38005303	SPRING 52N/mm L=250mm	1														
36	R38005304	SPRING 52N/mm L=240mm	1														
36	R38005403	SPRING 54N/mm L=240mm	1														
36	R38005603	SPRING 56N/mm L=240mm	1														
36	R38005202	SPRING 51 N/mm	1		o												
36	R38005401	SPRING 53N/mm	1	o													
36	R38005203	SPRING 52 N/mm	1			o											
36	R38005602	SPRING 56N/mm	1														o



2009-2017 Rear Cushion-Parts List

	REFERENCE	NAME PART	QTY	15	16	17	09	10	11	13	09	10	11	13	14	13	17
				KXF450	RMZ 250	RMZ 450											
47	R12201601	JOINT ROD COMP	1														
47	R12201602	JOINT ROD COMP	1														
47	R12201603	JOINT ROD COMP	1														
47	R12201604	JOINT ROD COMP	1														
47	R12201605	JOINT ROD COMP	1	o													
47	R12201606	JOINT ROD COMP	1														
47	R12201607	JOINT ROD COMP	1	o													
47	R12201608	JOINT ROD COMP	1														
47	R12201609	JOINT ROD COMP	1			o											
47	R12201801	JOINT ROD COMP	1				o										
47	R12201802	JOINT ROD COMP	1						o								
47	R12201803	JOINT ROD COMP	1					o	o	o		o	o	o	o	o	o
47b	R30001601	ROD Ø16 L257mm	1			o											
47b	R30001602	ROD Ø16 L257mm	1														
47b	R30001603	ROD Ø16 L254mm	1	o	o												
47b	R30001801	ROD Ø18 L250mm	1						o								
47b	R30001802	ROD Ø18 L248mm	1				o										
47b	R30001803	ROD Ø18 L254mm	1					o	o	o		o	o	o	o	o	o
47c	R41001601	LOCK NUT Ø16	1	o	o	o											
47c	R41001801	LOCK NUT Ø18	1				o	o	o	o	o	o	o	o	o	o	o
47d	R34000004	O RING	1				o	o	o	o		o	o	o	o	o	o
47e	R29900003	PUSH ROD	1														
47e	R29900004	PUSH ROD	1														
47e	R29900005	PUSH ROD	1			o											
47e	R29900006	PUSH ROD	1				o	o	o		o	o	o	o	o	o	o
47e	R29900007	PUSH ROD	1				o										

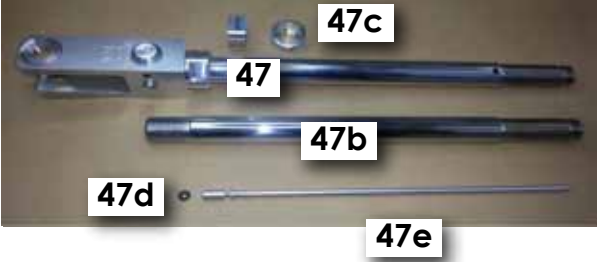

2017 Rear Cushion CRF 450 - Parts List



REFERENCE	NAME PART	QTY	17 CRF 450
1	R55101601	NUT,HEX	1
1	R55101401	NUT,HEX	1
2	R25005001	PISTON RING	1
2a	R24005001	PISTON	1
2a	R24005002	PISTON	1
2a	R24005003	PISTON	1
2a	R24005004	PISTON	1
37	R34505001	PACKING	1
38	R35205001	BUCK UP RING	2
39	R25005002	PISTON RING	1
39	R25005002	PISTON RING	2
3	R34005001	O RING	2
5	R26901601	OIL SEAL GUIDE	1
6	R33001601	DUST SEAL	1
7	R27501601	GUIDE BUSH	1
4	R32001601	OIL SEAL	1
4	R32001801	OIL SEAL	1
4a	R35201801	BUCK UP RING	1
5	R26901801	OIL SEAL GUIDE	1
6	R33001801	DUST SEAL	1
7	R27501801	GUIDE BUSH	1
8	R38800001	REBOUND RUBBER	1
8	R38800002	REBOUND RUBBER	1
9	R34005002	O RING	1
10	R36600001	STOPPER RING	1
40	R38502301	REBOUND SPG L=23mm	1
40	R38502302	REBOUND SPG L=23mm	1
40	R38502701	REBOUND SPG L=27mm	1
41	R27301602	ROD GUIDE CASE	1
41	R27301601	ROD GUIDE CASE	1
41	R27301801	ROD GUIDE CASE	1
11	R41501601	STOPPER RUBBER	1
11	R41501602	STOPPER RUBBER	1
11	R41501801	STOPPER RUBBER	1





2017 Rear Cushion CRF 450 - Parts List



	REFERENCE	NAME PART	QTY	17 CRF 450	
12a	RB3200001	PLUG BOLT COMP	1		
12a	RB3200002	PLUG BOLT COMP	1		
12a	RB3200003	PLUG BOLT COMP	1		
12a	RB3200004	PLUG BOLT COMP	1		
12a	RB3200005	PLUG BOLT COMP	1		
12a	RB3200006	PLUG BOLT COMP	1	○	
20	RB3200007	PLUG BOLT COMP	1		
12a	RB3200008	PLUG BOLT COMP	1		
12a	RB3200009	PLUG BOLT COMP	1		
12a	RB3200010	PLUG BOLT COMP	1		
12	R34000001	O RING	1	○	
13	R34000002	O RING	1	○	
14	R36700001	STOPPER RING B	1	○	
15	R34000003	O RING	1		
17	R36600002	STOPPER RING	1		
18	R55100601	NUT,HEX	1	○	
19	R29606001	BLADDER	1		
19	R29610502	BLADDER	1		
19	R29610301	BLADDER	1		
19	R29609601	BLADDER	1	○	
20a	R45500001	AIR VALVE	1	○	
20	R46800001	AIR VALVE CORE	1	○	
21	R15700001	AIR VALVE CAP COMP	1	○	
22	R36600004	STOPPER RING	1		
22a	RB0600001	CHAMBER CAP COMP	1		
22a	R60700001	CHAMBER CAP COMP	1	○	
22a	RB0600002	CHAMBER CAP COMP	1		
22a	RB0600003	CHAMBER CAP COMP	1		
22a	RB0600004	CHAMBER CAP COMP	1		
22a	RB0600005	CHAMBER CAP COMP	1		
22	R36600003	STOPPER RING	1	○	
23	R47500001	SPHERICAL BEARING	1	○	
24	R36600005	STOPPER RING	1	○	
25	0	DUST SEAL	1	○	
26	0	DUST SEAL	1	○	
27	R75100001	NEEDL BEARING	1		
27	R75100002	NEEDL BEARING	1		
29	R33000003	DUST SEAL	2		
30	R50800001	COLLAR	1		
31	RR8000004	COLLAR B	1		

2017 Rear Cushion CRF 450 - Parts List



REFERENCE	NAME PART	QTY	17 CRF 450		
32	RF6300001	SPG ADJ NUT	1		
33	R39100001	SPG ADJ	1		
32	RF6300002	SPG ADJ NUT	1		○
33	R39100002	SPG ADJ	1		○
32	RF6300003	SPG ADJ NUT	1		
33	R39100003	SPG ADJ	1		
34	R39300001	SPG SEAT B	1	○	
35	R36800001	STOPPER RING C	1	○	
36	R38005001	SPRING 49N/mm	1		
36	R38005101	SPRING 50N/mm	1		
36	R38005201	SPRING 51 N/mm	1		
36	R38005301	SPRING 52N/mm	1		
36	R38005402	SPRING 53N/mm	1		
36	R38005501	SPRING 54N/mm	1		
36	R38005601	SPRING 55N/mm	1		
36	R38005701	SPRING 56/Nmm	1		
36	R38005801	SPRING 57N/mm	1		
36	R38005502	SPRING 54N/mm	1		
36	R38005702	SPRING 56N/mm	1		
36	R38005802	SPRING 57/Nmm	1		
36	R38005901	SPRING 58N/mm	1		
36	R38005302	SPRING 52N/mm	1		
36	R38005303	SPRING 52N/mm L=250mm	1		
36	R38005304	SPRING 52N/mm L=240mm	1		L
36	R38005403	SPRING 54N/mm L=240mm	1		○
36	R38005603	SPRING 56N/mm L=240mm	1		H
36	R38005202	SPRING 51 N/mm	1		
36	R38005401	SPRING 53N/mm	1		
36	R38005203	SPRING 52 N/mm	1		
36	R38005602	SPRING 56N/mm	1		

L = light -2N/mm

H= heavy +2N/mm